



SALE PRICE £170,000

zero service charge
£150 pa ground rent

Stylish One-Bedroom First Floor Apartment in Prime Waltham Abbey Location

Duncan Phillips is delighted to offer this beautiful one-bedroom first floor apartment situated in the heart of Waltham Abbey town centre. This stunning home is just moments from local amenities and transport links. Boasting a fitted kitchen & WC on the first floor, a large double bedroom, spacious lounge & contemporary bathroom on the second floor.

Don't miss out on this fantastic home—contact us today to arrange a viewing!

EPC Rating D
Council Tax Band B

Entrance

Kitchen

3.03m x 2.77m (9'11" x 9'1")

WC

1.22m x 1.12m (4'0" x 3'8")

Reception/Diner

4.15m x 3.22m (13'7" x 10'6")

Bedroom

4.15m x 2.28m (13'7" x 7'5")

Bathroom

1.48m x 1.44m (4'10" x 4'8")

Additional Information

105 year lease remaining

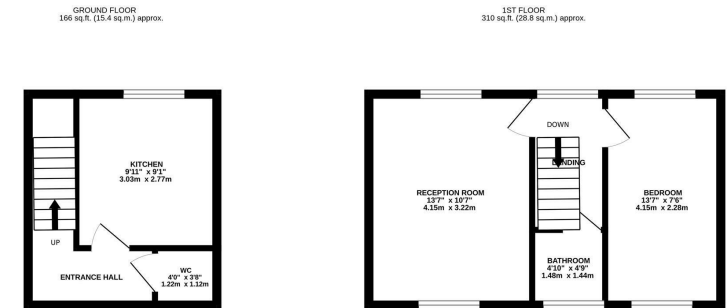

TOTAL FLOOR AREA - 476 sq.ft. (44.2 sq.m.) approx.
While every attempt has been made to ensure the accuracy of the floorplan contained here, measurements of doors, windows, rooms and any other items are approximate and no responsibility is taken for any error, omission or misstatement. This plan is to be used as a guide only and should be used in conjunction with any prospective purchaser. The services, systems and appliances shown have not been tested and no guarantee is given as to their operability or efficiency over the given.
Made with Metropix 02025

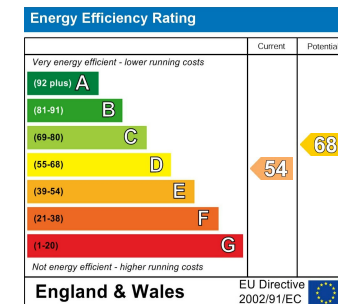

Suite 1, Elmhurst 98-106 High Road, South Woodford, London, E18 2QH
01992701133
info@duncanphillips.co.uk
www.duncanphillips.co.uk